

SITE INFORMATION DOCUMENT

| | | |
|--|--|---------------------------------|
| PREMISES | Bold Tendencies Levels 7-10, Multi-Storey Car Park, 95a Rye Lane, London SE15 4ST | Locality's REF : LOC2569 |
| NEAREST A&E | King's College Hospital, SE5 9RS Tel: 020 3299 9000 | |
| <p>Bold Tendencies is a not-for-profit arts organisation based in the rooftop spaces at Peckham Multi-Storey Car Park.</p> <p>During your recess the public may be present</p> | | |
| <p>ROOF TOP open air</p> <p>Floor 9 south side with ramp</p> <p>Floor 10 North side City views</p> | <p>Vehicles or hard-wheeled trolleys are not permitted on Level 9 and 10. Any marks left from wheels will be considered damage.</p> <p>The artwork (silver painted line) on the roof must not be featured expansively in any shots. Fragments of the artwork may be featured, however you must not be able to identify the work in its entirety. The artworks on the rooftop are under copyright and must not be featured.</p> <p>Vehicles or hard-wheeled trolleys are not permitted on Level 9 and 10. Any marks left from wheels will be considered damage. Any damage to the floor on Level 10 or Observatory will have a minimum repair charge of £300 +VAT.</p> <p>DO NOT photograph or film any of the work of art on the roof. If you are unsure as to where these are please speak to a member of Bold Tendencies staff. No running on the Observatory.</p> | |
| <p>PRODUCTION SPACE Level 7</p> <p>Covered space</p> | <p>Bold Tendencies will provide basic kitchen goods, such as a kettle, fridge and coffee mugs. Please ensure that mugs and glasses are washed up by the end of the hire period.</p> <p>The layout of the production space must be returned to the way it was found by the end of the hire period. The production space has potable cold water. Steamers, irons and other high wattage devices must run off of the 32A supplies. Any damage to the furniture will carry a minimum cleaning/repair cost of £100+VAT.</p> | |
| <p>STRAW AUDITORIUM Level 7</p> <p>Covered space</p> | <p>The lighting within the Auditorium is dimmable. Please ask your security person or Bold Tendencies representative for a demonstration. Please ensure that heaters (or any other heat emitting devices) are kept away from the straw walls. Haze is not permitted in any enclosed space, unless agreed in advance and a method statement provided. There are smoke alarms located in all enclosed spaces.</p> | |
| <p>Pink Staircase</p> | <p>Is considered an art work and under copyright of the artist. Lighting is provided as is. It cannot be switched off. You may block out the lights with temporary, easily removable shielding as long as this does not pose any risk to individuals. Any shielding used must be removed by the end of your hire time. Do not remove the bulbs from the lighting units. You may not modify the walls or floor in any way or remove any signage. This includes, but is not limited to, painting, drilling, glueing etc. Any damage to the walls or floor will have a minimum repair charge of £300 +VAT</p> | |
| <p>ACCESS</p> | <p>Access is via the lifts, pink staircase or ramps. There is no vehicular access to the roof.</p> | |
| <p>CAR PARKING</p> | <p>There is pay and display parking on the ground floor. The postcode for vehicles is SE15 5HQ. We cannot reserve parking.</p> | |
| <p>INSURANCE</p> | <p>Proof of public liability insurance is required to a value of £10m.</p> | |

| | |
|-------------------------|--|
| LIFTS | The lifts are under the management of Peckham Levels. While the lifts are in good working order we cannot predict or foresee breakdowns. If in the unlikely scenario that both lifts are out of service then access to our space will be given via the car ramps from the ground floor and via the pink stairwell. You must be accompanied by a member of staff to use the lifts. There is key-access to floor 7 and our staff hold the key. |
| ELECTRICITY | Is provided on site and a map of power points is provided below. Please provide own extension cables. If you are bringing heaters on to site (or other high-wattage devices) we recommend that these be plugged into the 32A supply. Owner does not responsible for any damage caused to equipment if you overload the 13A supplies. |
| DELIVERIES / DROP OFF's | within your allocated hire times (unless previously arranged with us). Owner cannot take deliveries on your behalf before the hire times, and deliveries left outside of our demise are your responsibility. Delivery address is Cerise Road, SE15 5HQ. |
| RISK ASSESSMENTS | Production to provide its own risk assessments and health and safety advisor to ensure the welfare of your crew and cast. The owner does not accept responsibility for any injuries, loss or damage whatsoever sustained while on the Premises. |
| EVACUATION | Unless informed otherwise, evacuation is via the pink staircase. Please request a map if necessary. In the event of evacuation please follow direction from your security team or Bold Tendencies representative. |
| FLAME / FIRE | Naked flame, equipment that sparks or any pyrotechnics require advanced permission. No open fires are permitted on site. No smoking or vaping on site. |
| RUBBISH / WASTE | The production MUST remove all waste it creates from the site. Failure to comply will result in charges to clean up. |
| SIGNAGE | Directional signage may be placed within the Premises but it must be removed upon completion. Never remove, cover or block emergency signage. |
| SECURITY | The site can be locked. The Owner does not accept liability for any loss or damage to items brought into the Premises. Production may supply their own security. Overnight stays to be agreed in advance. |
| DRONES | Are not permitted on site unless agreed in advance. |

Power Supplies at Bold Tendencies

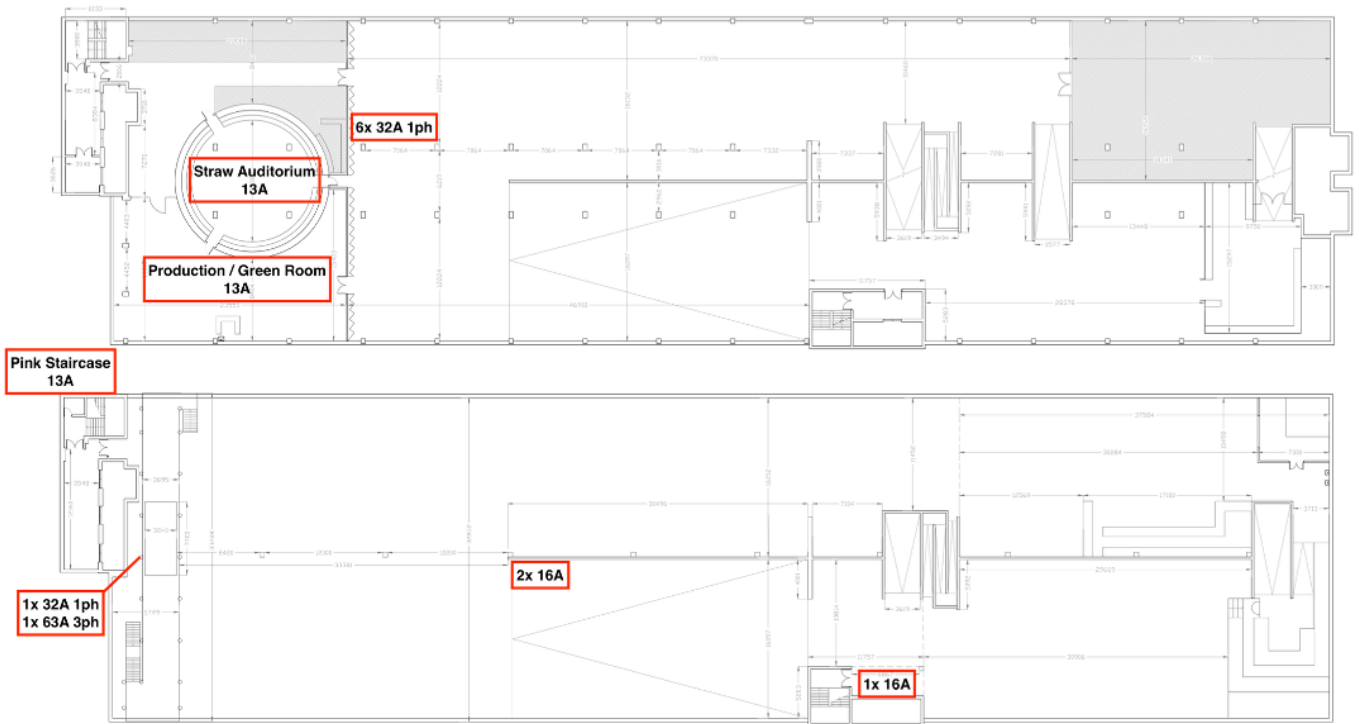

Floors 7 and 8 (7 has straw auditorium)

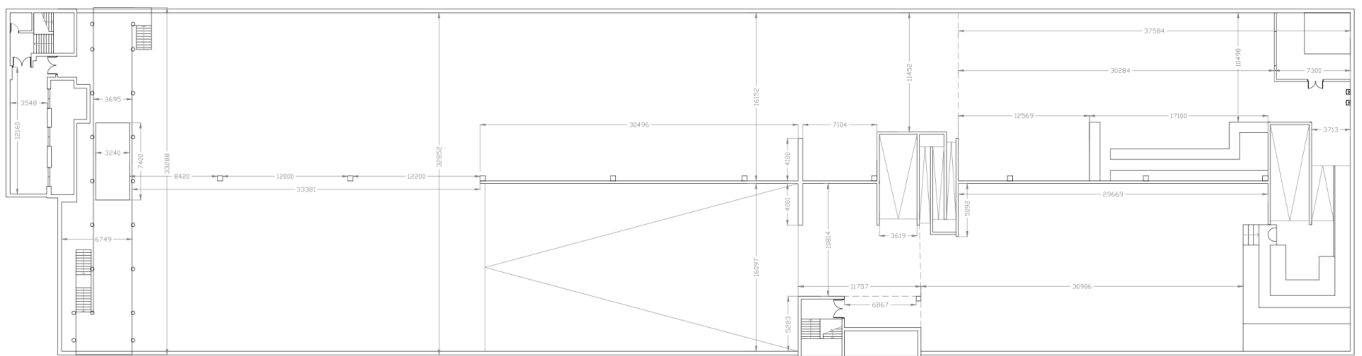

Floors 9 and 10